

DISASSEMBLY

NOTICE:

When using a vise, do not overtighten it.

1. REMOVE TRANSPONDER KEY COIL

Remove the screw and transponder key coil.

2. REMOVE KEY CYLINDER LAMP ILLUMINATION

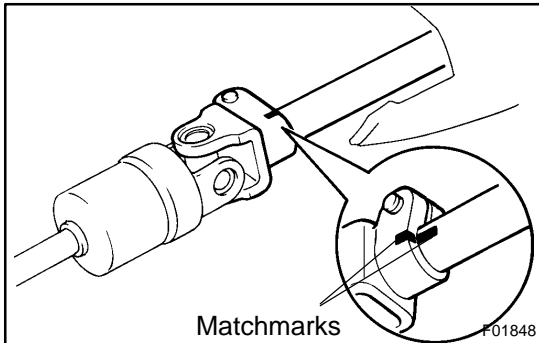

3. REMOVE NO. 2 INTERMEDIATE SHAFT ASSEMBLY

- Place matchmarks on the No. 2 intermediate shaft assembly and main shaft.
- Remove the bolt and No. 2 intermediate shaft assembly.

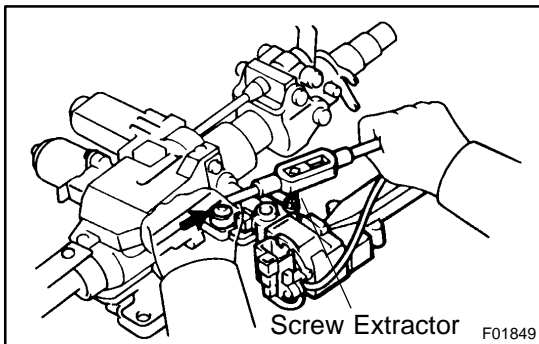

4. REMOVE COLUMN UPPER BRACKET

- Using a centering punch, mark the center of the 2 tapered-head bolts.
- Using a 4 – 5 mm (0.16 – 0.20 in.) drill, drill into the 2 bolts.
- Using a screw extractor, remove the 2 bolts and column upper bracket.

5. REMOVE COLUMN TUBE SUPPORT

- Remove the bolt and column tube support with tube attachment.
- Remove the tube attachment from the tube support.

6. REMOVE TURN SIGNAL BRACKET

Remove the 3 bolts and turn signal bracket.

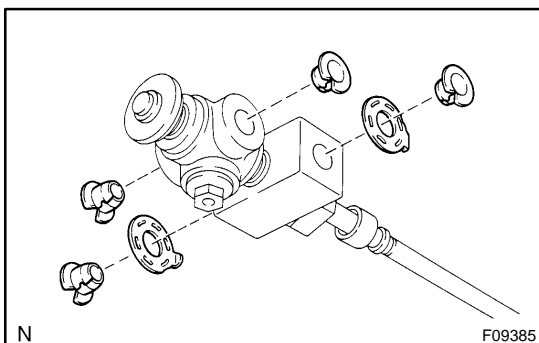

7. REMOVE TILT SLIDER ASSEMBLY

- Using a hexagon wrench, remove the 4 bolts, 2 washers and tilt slider assembly.
- Remove the 4 bushings, 2 plates from tilt slider assembly.

8. REMOVE NO. 1 BRACKET

Remove the bolt and No.1 bracket.

9. REMOVE NO. 2 BRACKET

Remove the bolt and No. 2 bracket.

10. REMOVE TILT AND TELESCOPIC ECU

Remove the 2 bolts and tilt and telescopic ECU.